

OPERATOR'S MANUAL



2018 & 4018

Hay Tedder

Model 2018 & 4018



Operating Your Hay Tedder

IMPORTANT!

Before operating the operator must be familiar with the operator's manual and instructed on the operation of the tractor and the machine.

Do not allow any unqualified persons or someone under the influence of an intoxicating substance or medicine to operate this equipment.

Raising and lowering the wings on the tedder should only be done while the tedder hitch is attached to a tractor. CAUTION!! Make sure all personnel and pets are clear of the area before raising and lowering the tedder wings or engaging the power source.

NEVER ENGAGE THE POWER SOURCE WHILE THE TEDDER WINGS ARE IN RAISED POSITION.

After doing any work on the hydraulics always operate the hydraulics through several cycles to dispel any air in the system (air in the lines may cause the wing to drop abruptly).

Adjust the tilt of the machine until the teeth are slightly touching the ground.

Adjust the rotating speed until you receive the desired spread pattern. Slower will slightly windrow it and faster will spread the crop more evenly. This will vary with crop texture and weight.

DO NOT OVER SPEED.

USE ONLY ENOUGH SPEED TO GET THE DESIRED RESULTS.

Lubrication and Maintenance

Lubricate grease fittings every 10 hours.

Check oil level in gearbox every day of use. Refill with S.A.E. #90 Gear Oil.

Every 10 hours check all bolts nuts and tines; tighten as needed.

Keep all shields in good repair and properly attached.

Do not operate with shields or guards missing.

Storage

Always tilt the tedder to working position before unhooking; having the tedder tilted back too far can cause it to overbalance and fall backwards.

Warranty

Esch Hay Equipment

Esch Hay Equipment, LLC. Hereinafter called the company warrants to each purchaser of E.H.E. Farm Equipment from an authorized E.H.E. Dealer that such equipment is free of defects in material and workmanship (except tires, tubes and engines which are warranted by the respective manufacturer) according to the following provisions.

All Warranty periods begin with the date of the first retail sale or first use, whether it be through rental lease or special demonstration program, whichever comes first. This is for the benefit of the original or subsequent purchaser during the warranty period.

The warranty only applies if the equipment has been used and serviced in accordance with the recommendations in the operators manual. The basic equipment warranty shall be 12 months. The obligation of the company under this warranty is limited to repairing or at its option replacing any part(s) which in the company's judgement is defective.

The company shall have no obligation or liability of any kind on account of any of its equipment and shall not be liable for special or consequential damages. The company makes no other warranty express or implied and specifically. The company dis claims, any implied warranty of merchantability or fitness.

The customer shall be responsible for payment of travel time to the machine or to deliver the machine to the dealer's service shop for repair. E.H.E. Warranty does not cover travel time. E.H.E. shall not be responsible for normal replacement parts such as belts, chains and teeth.

Full Lifetime Warranty

EHE guarantees tine arms on this hay tedder for life, against breakage. If tine arms ever break, return arm to EHE for free replacement. EHE will cover shipment of new arms anywhere in the contiguous U. S.

Warranty does not cover alteration of any type. Alterations include, but are not limited to cutting, bending, punching, drilling, welding, and heating.

This warranty covers all previously made models or machines.

Assembly

IMPORTANT: Tedder Rotors must be in phase!

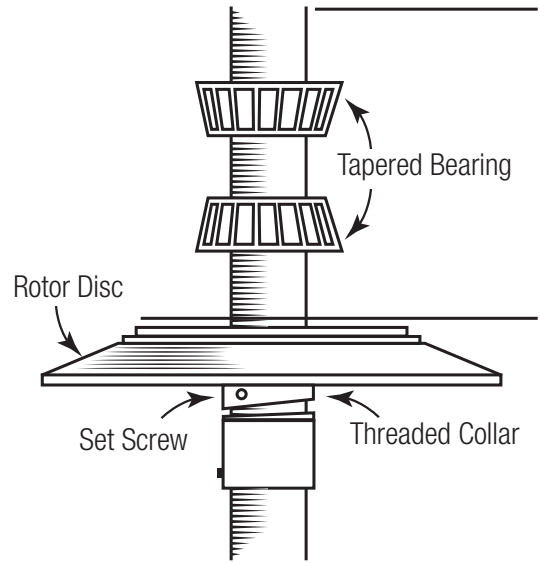
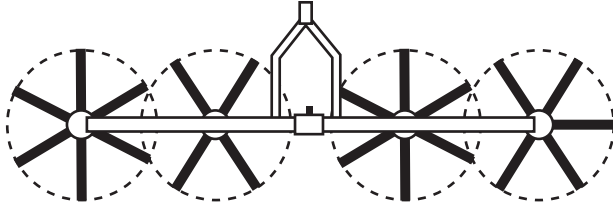

Correct Rotor Phase

Check to make sure all rotors are in phase. When disassembling gearbox housing, it is important to mark with a magic marker each external and internal gearbox housing at any point on the lower portion of the casing. At the same time, mark the arm holder flange in the same spot so the unit can be kept in phase. (See Illustration above)

Preload Adjustment

To set the preload on the spinner bearings, loosen the set screw on the tapered collar and turn the collar until all end play is taken out of the rotor disc.

CHECK THIS ADJUSTMENT ANNUALLY

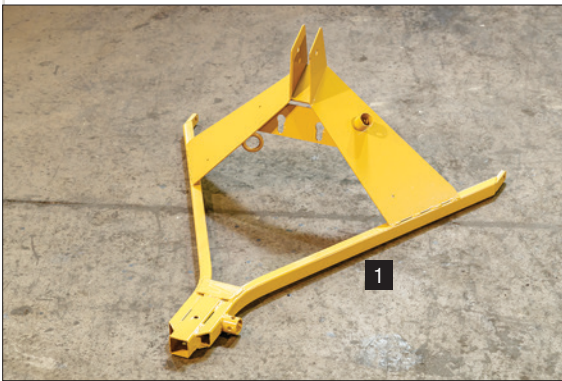

Ref#	Part#	Qty. Used	Description
1	1821	1	Hitch Assembly
2	1801	1	2018/4018 Center Frame Assembly
3	1802	1	2018/4018 Left Wing Assembly
4	1803	1	2018/4018 Right Wing Assembly
5	1485	1	2018/4018 RH Wing Guard
6	1486	1	2018/4018 LH Wing Guard

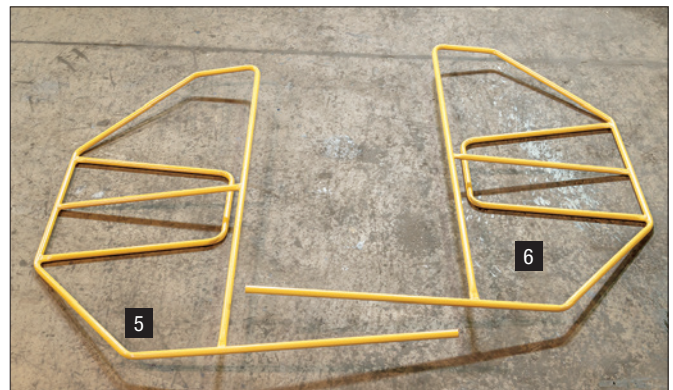

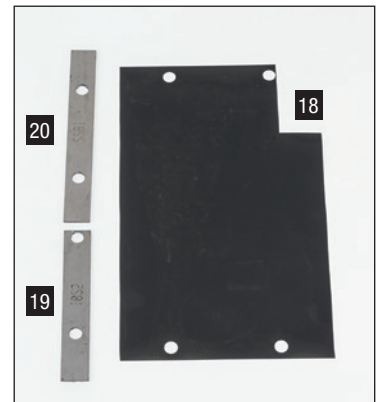
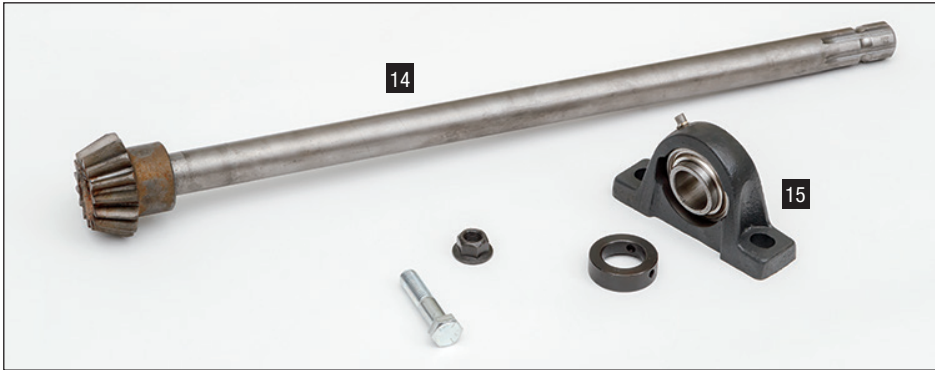
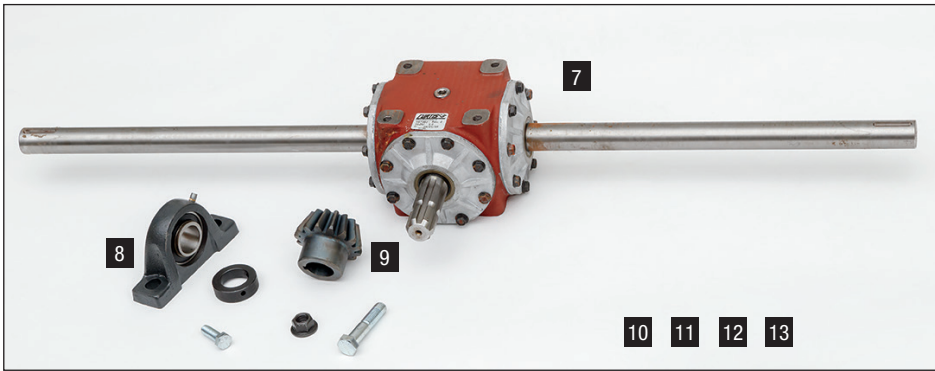

Ref#	Part#	Qty. Used	Description
7	1438	1	2018/4018 Gear Box Assembly
8	1439	2	Pillow Block Bearing
9	1440	2	Pinion Gear
10*	1478	AR	1 3/8" Shim Washer .031"
11*	1479	2	5/16" x 1 1/2" Keystock
12*	1455	3	Gearbox Seal (13569)
13*	1100	4	Gearbox Bearing
14	1441	2	2018/4018 Wing Pinion Shaft
15	1439	4	Pillow Block Bearing
16	1443	4	6" x 20" 6 Lug Steel Wheel
17	1817	4	Tire with 6 Lug Rim
18	1442	2	Rubber Cover
19	1822	2	Rubber Cover Strap
20	1825	2	Rubber Cover Strap
21	1482	1	Tilt Assembly Link
22	1483	1	Tilt Crank Screw
23	1484	1	Tilt Crank
24	1418	1	Tilt Crank Knob
25	1430	1	Bronze Bearing Washer
26	1414	1	Front Tilt Assembly Tube



*Not Pictured

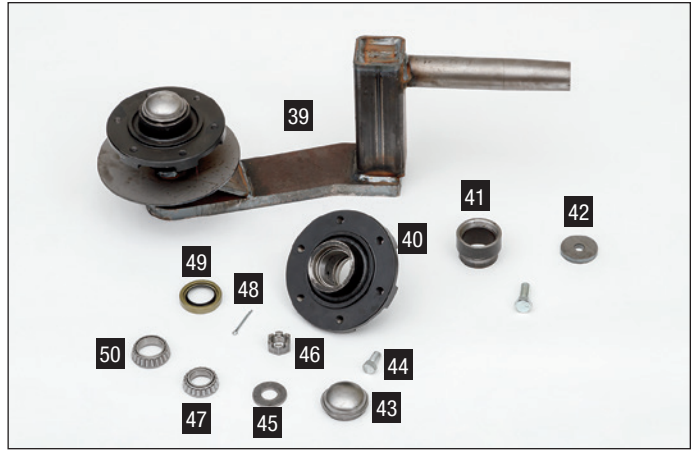
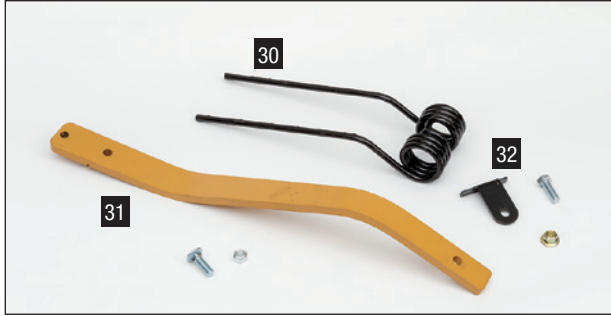

Ref#	Part#	Qty. Used	Description
27	2060-R	2	Wheel Guard RH
28	2060-L	2	Wheel Guard LH
29	2066	4	Wheel Guard Mount Bracket
30	1405	24	Tedder Tine
31	1800-1	24	2018/4018 Tine Arm
32	1854	24	Tine Clip
33	1447	1	Hose Carrier Rod
34	2050	1	Hose Carrier Bracket
35	4002	2	Pinion Box
36	1810	2	Short Pinion Shaft
37	20722	4	207-22 Bearing with Collar
38	1466	8	207 Bearing Flange
39	1445	4	Axle and Spindle Assembly
40	1075	4	888 Wheel Hub 6 Lug
41	1459	4	Adjusting Collar
42	1417	4	Top Spindle Washer
43	1460	4	888 Hubcap
44	1461	24	1/2" - 20 x 1 1/4" Lug Bolt
45	1462	4	7/8" Plain Washer
46	1463	4	7/8" - 14 Slotted Nut
47	1056-A	4	Outer Wheel Bearing (67048-888)
48	1465	4	5/32" x 1 1/2" Cotter Pin
49	1074	4	Seal (16289-888)
50	1071	4	Inner Wheel Bearing (69349-888)
51	1420	1	15" Sidewind Jack

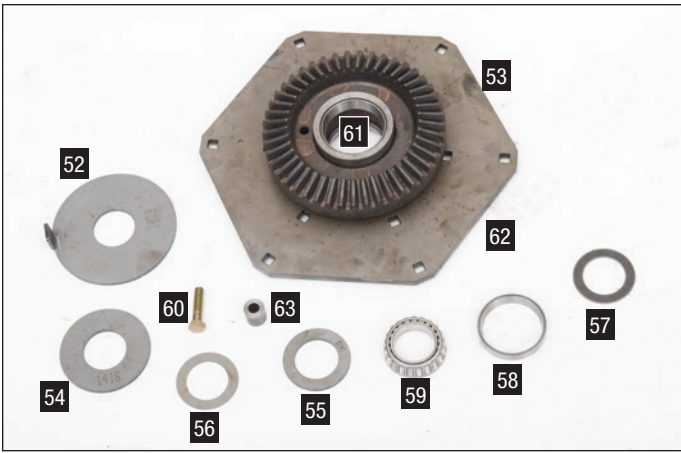

4018 Spinner Gear Assembly

Ref#	Part#	Qty. Used	Description
52	1413	4	Grease Flinger
53	1451	4	Complete Spinner Gear Assembly
54	1416	4	Dust Cover Washer
55	1415	4	Bottom Spacer Washer
56	1470	AR	Light Shim Washer .031"
57	1469	AR	Heavy Shim Washer .080"
58	1467	8	Spinner Bearing Race (104912)
59	1468	8	Spinner Bearing (104949)
60	1474	24	1/2" x 2" GR 8 Bolt
61	1475	4	4018 Ring Gear Only
62	1452	4	4018 Spinner Plate Only
63	1473	24	Spinner Spacer

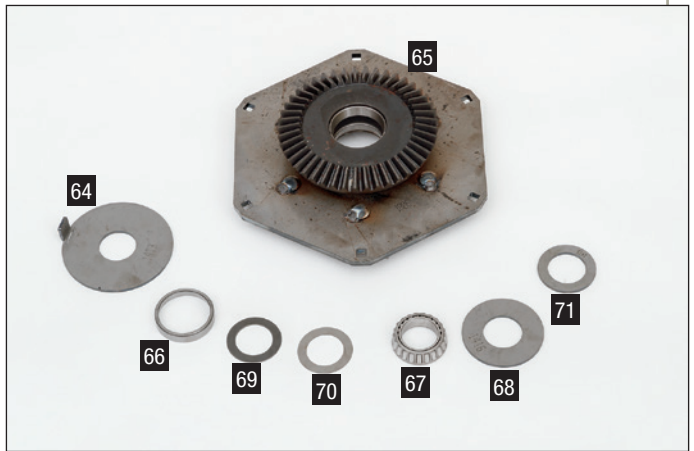

2018 Spinner Gear Assembly

Ref#	Part#	Qty. Used	Description
64	1413	4	Grease Flinger
65	1806	4	Spinner Plate Gear Assembly
66	1467	8	Spinner Bearing Race (104912)
67	1468	8	Spinner Bearing (104949)
68	1416	4	Dust Cover Washer
69	1469	AR	Heavy Shim Washer .080"
70	1470	AR	Light Shim Washer .030"
71	1415	4	Bottom Spacer Washer

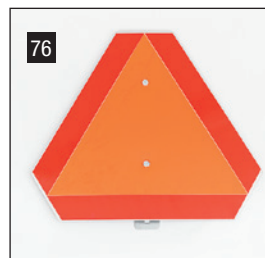
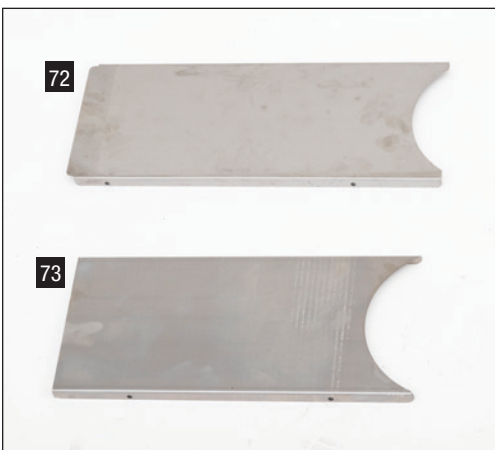

Ref#	Part#	Qty. Used	Description
72	1815	2	Wing Shield
73	1813	2	Center Shield
74	1812	2	Wing Lift Cylinder
75	1435	1	PTO Cover
76	1437	1	SMV Emblem (With Mounting Spade)
77	1436	1	Manual Canister
78	1481	1	2018/4018 PTO Shaft

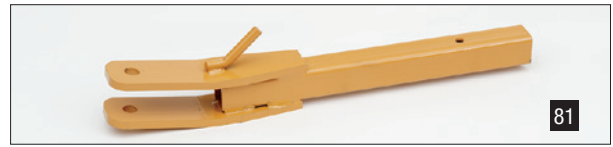
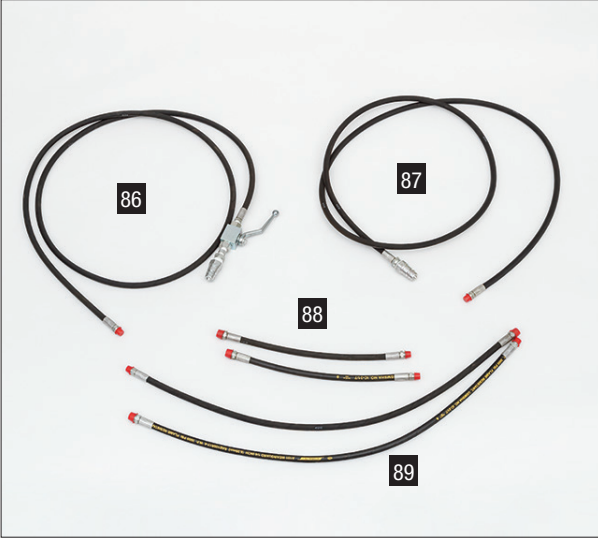
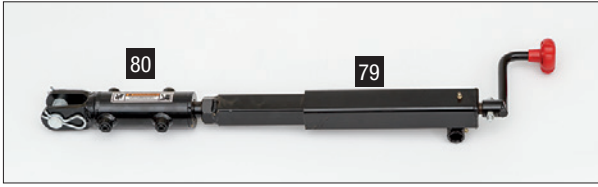

Ref#	Part#	Qty. Used	Description
79	1429	1	Complete Tilt Crank Assembly
80	1495	1	Hydraulic Tilt Cylinder
81	4004	1	Hitch Extension
82	1487	1	Warranty Decal
83	1488	1	Large Warning Decal
84	1489	1	Rectangular Warning Decal
85	1490	1	Square Warning Decal
86	1431	1	Hydraulic Hose with Valve and Coupler Assembly
87	1432	1	Hydraulic Hose with Coupler
88	1433	2	Short Cylinder Hose
89	1434	2	Long Cylinder Hose
90	1498	4	Pivot Bearing
91	1499	4	Spacer
92	1453	2	Double Joint